

# WiFi configuration tutorial

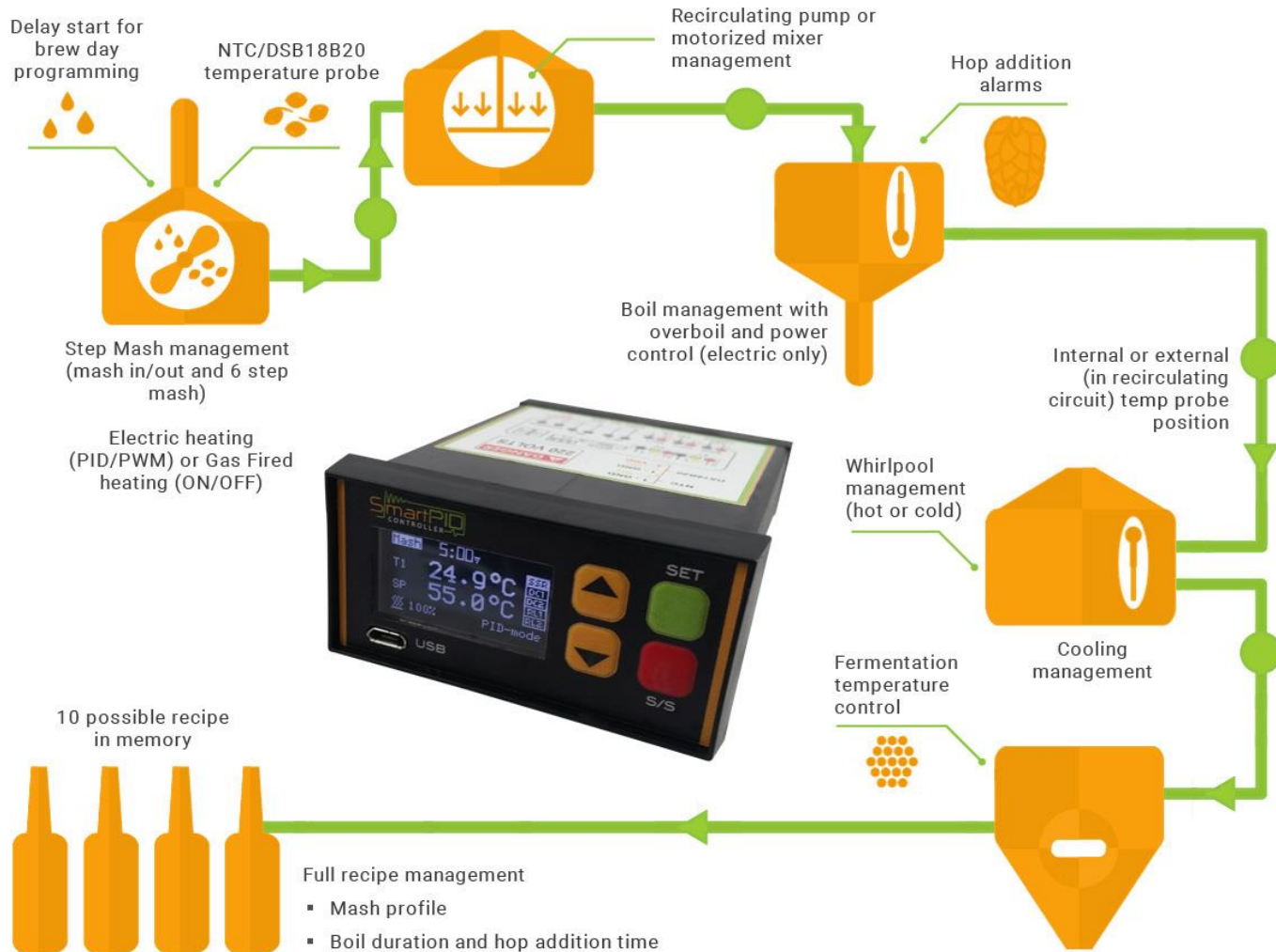

# SmartPID smart HomeBrewing MQTT server architecture

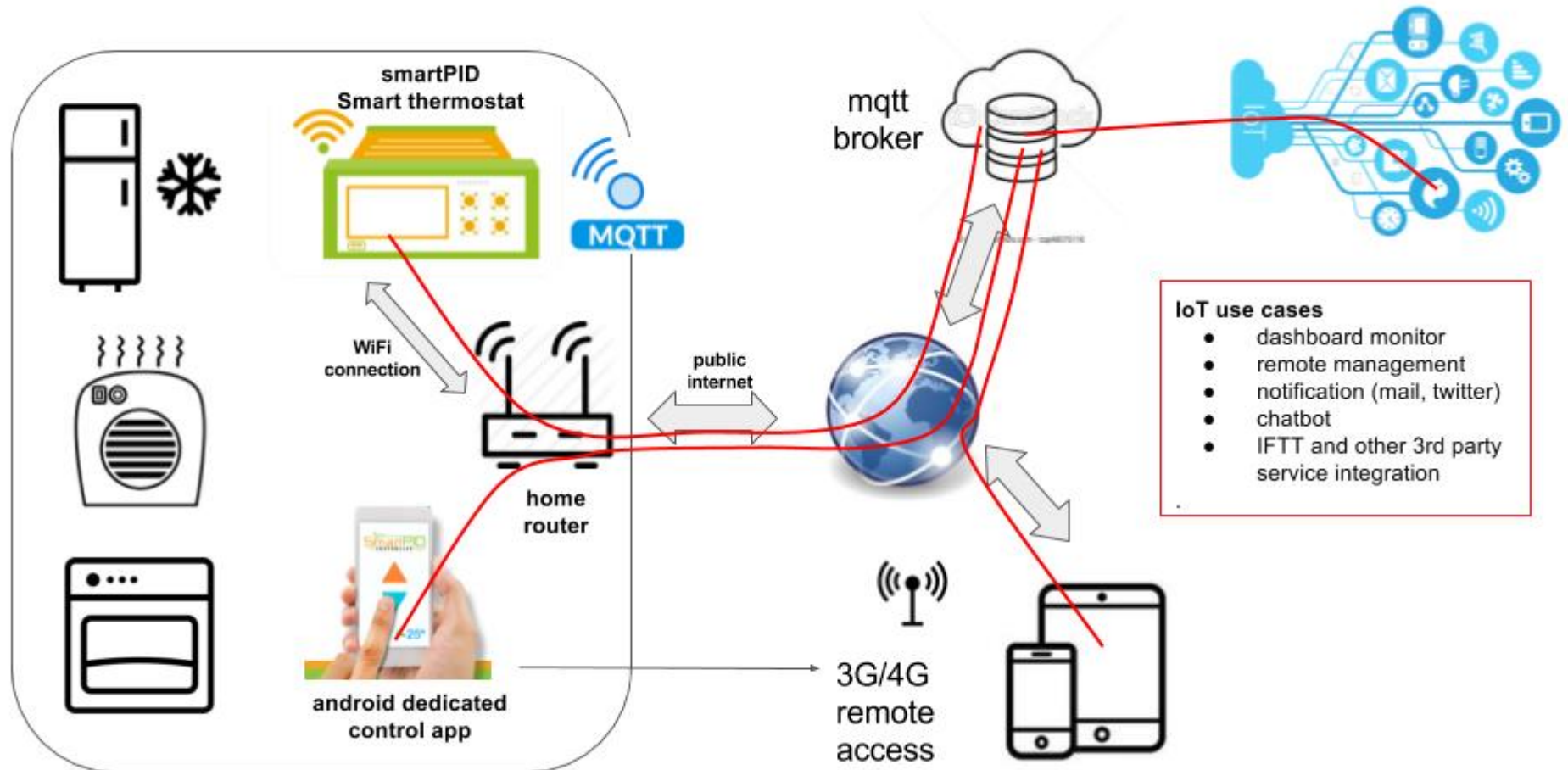

# SmartPID smart HomeBrewing WiFi config and remote server connection

In order to connect SmartPID controller to home WiFi network and to remote server and to the smartphone app 3 basic operation are need

SmartPID account creation (sign-up via app)

A light blue downward-pointing arrow indicating the flow from the first step to the second.

WiFi configuration and provisioning

A light blue downward-pointing arrow indicating the flow from the second step to the third.

SmartPID pairing with the app using serial number

# Credentials need to configure all the elements

Following data are need to complete the 3 steps

Make sure to write correctly (pay attention to capital letters, unwanted space, O and 0 etc..)

WiFi home network	<ul style="list-style-type: none"><li>• SSID (WiFi network name)</li><li>• Password</li></ul>
SmartPID account	<ul style="list-style-type: none"><li>• Login</li><li>• Password</li></ul>
SmartPID serial number	<ul style="list-style-type: none"><li>• 14 char unique string [visible on boot screen]</li></ul>



# SmartPID account creation



# step1.1



1. Start SmartPID smart thermostat app
2. Perform Sing-up process by pressing  
**NOT A MEMBER? SIGN UP NOW**



# step1.2



smartpid@arzaman.com|

Password

Confirm Password

REGISTER

ALREADY REGISTERED! LOGIN ME.

1. Insert valid email (need for recovery process)
2. Insert a personal password
3. Note the credentials for step 2

Powered  
BY SmartPID  
CONTROLLER



# step1.3



1. Login using credentials created
2. Press **LOGIN** to connect to the server

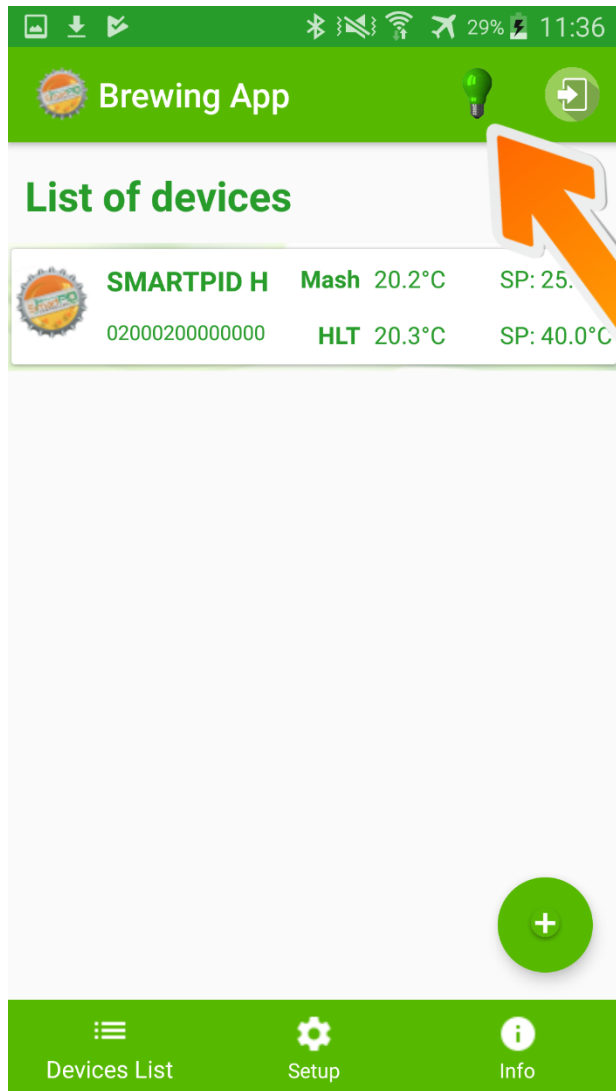

# step 1.4

1. Verify the connection status through the green light on the top bar
2. In case of red light check again credentials and internet connectivity

The logo is a circular badge with a grey gear-like border. Inside, there's an orange and yellow gradient background with a green waveform. The text 'SmartPID' is in green and 'CONTROLLER' is in smaller black letters below it.

# step 2

## SmartPID WiFi config & provisioning



# step2.1



1. Navigate to configuration connectivity/log configuration menu

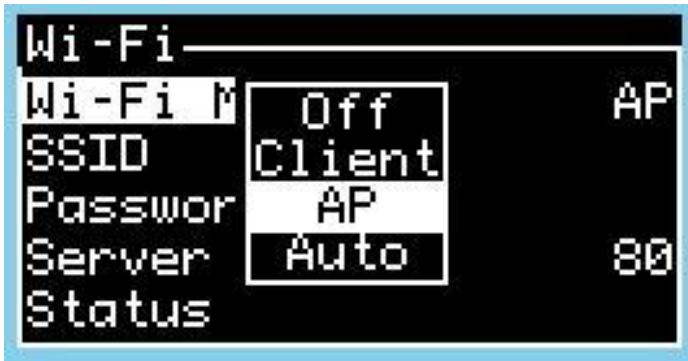

1. Configure "Wi-Fi mode" in AP mode



# step 2.2

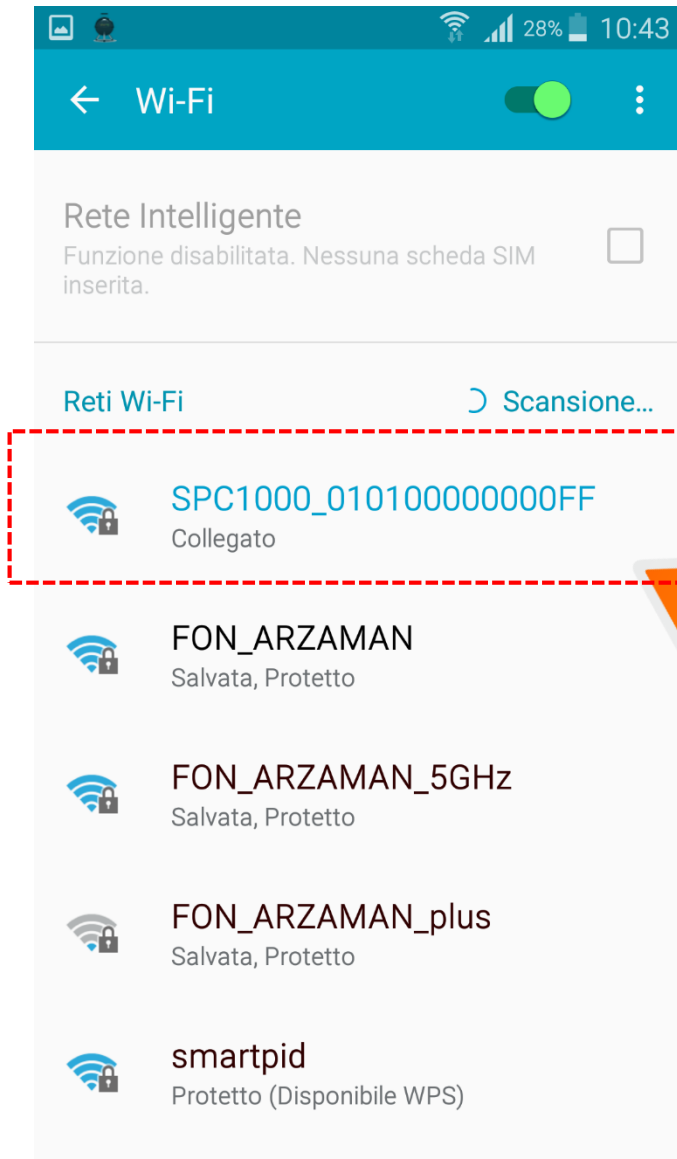

1. From smartphone , table or laptop scan the WiFi network
2. Highlight the SPC1000\_XXXXXXXXX
3. Select the special network and connect

**NOTE** it's strongly suggested to disconnect smartphone from 3g/4g connection during the whole operation

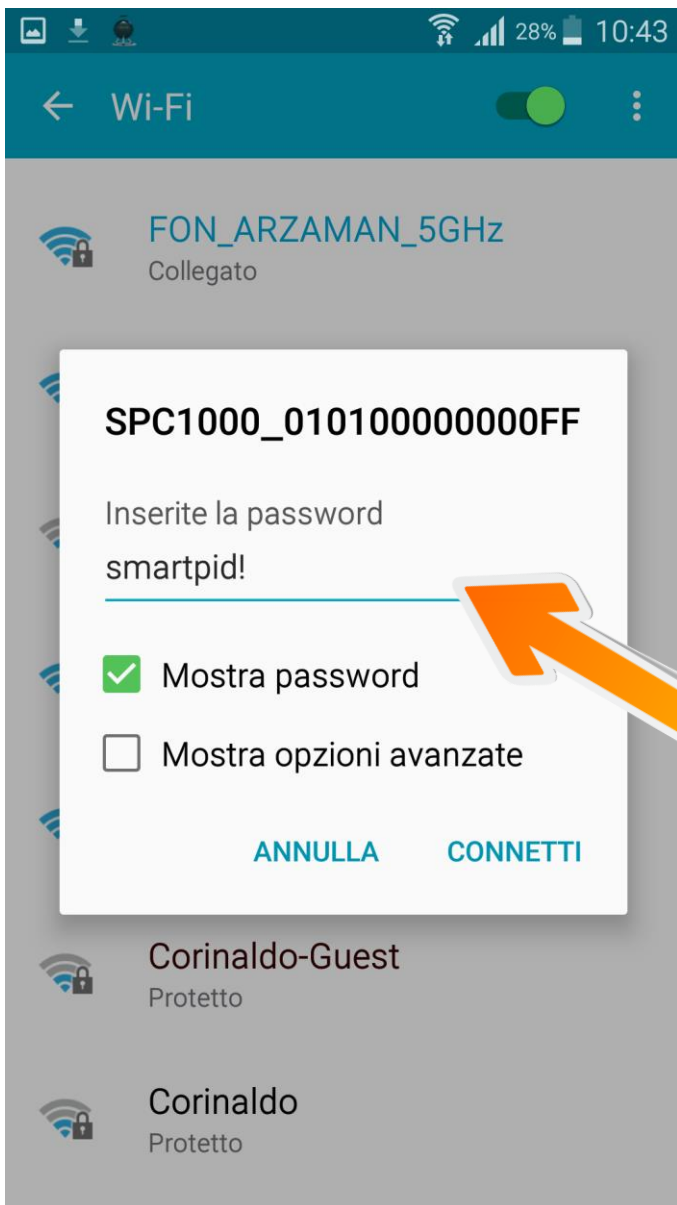

# step 2.3

1. Connect to WiFi network  
SPC1000\_XXXXXXXXXXXXXXXXXXXX
2. Default password is **smartpid!**

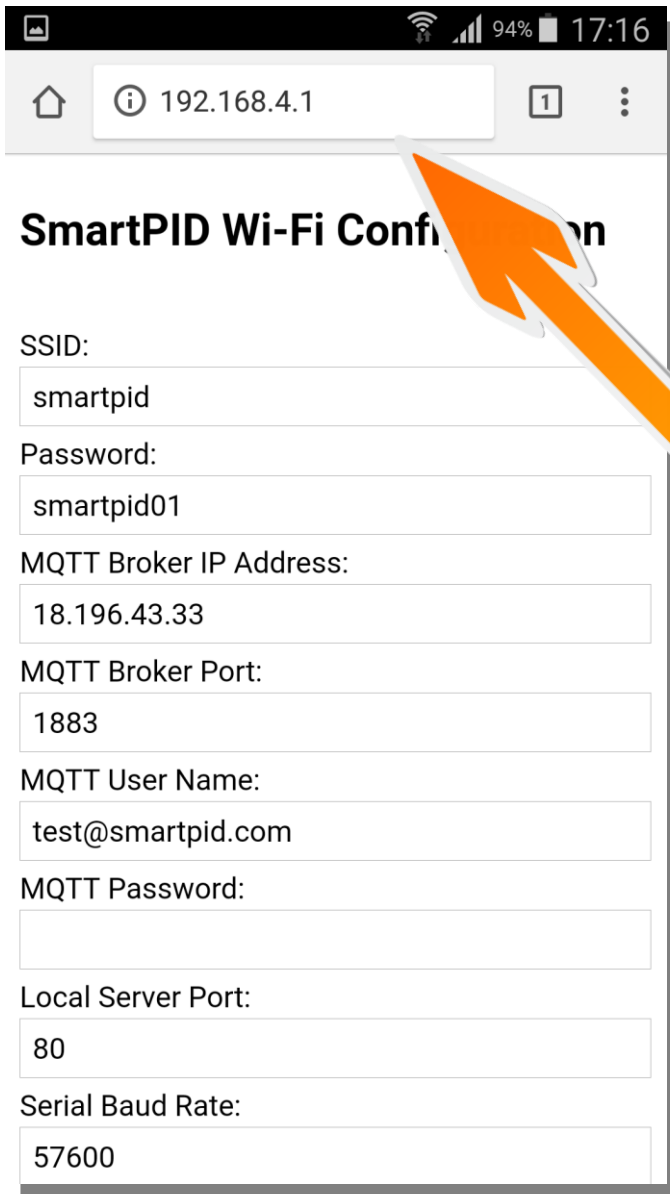

A screenshot of a mobile browser displaying the SmartPID Wi-Fi Configuration form. The browser's address bar shows the IP address 192.168.4.1. A large orange arrow points from the address bar to the SSID field. The form contains the following fields and values:

Field	Value
SSID:	smartpid
Password:	smartpid01
MQTT Broker IP Address:	18.196.43.33
MQTT Broker Port:	1883
MQTT User Name:	test@smartpid.com
MQTT Password:	
Local Server Port:	80
Serial Baud Rate:	57600



# step 2.4

1. Open any browser (chrome or other)
2. Input in the address bar following address  
**192.168.4.1**
3. You will be redirect to a landing page with a text form

SmartPID Wi-Fi Configuration

SSID:

Password:

MQTT Broker IP Address:

MQTT Broker Port:

MQTT User Name:

MQTT Password:

Local Server Port:

Serial Baud Rate:



# step 2.5

Username e Password  
WiFi home network

Server IP address and port  
**18.196.43.33**

SmartPID account  
username and PWD  
Created in step 1

Save data  
SmartPID will “reboot”





# step 2.6

```
Wi-Fi
Wi-Fi M Off Client
SSID Client
Passwor AP
Server Auto
Status
```

```
Wi-Fi
Wi-Fi Mode Client
SSID
Password
Server Port
Status
```

```
Wi-Fi Status
Connected
IP 123.123.123.123
SSID
123456789012345678901
23456789012
```

1. Go back to SmartPID menu WiFi/MQTT
2. Configure "Wi-Fi mode" as Client
3. Verify SSID e PWD of your home WiFi network
4. Verify "connected" connected status and assignment from your home router of a valid IP address



# step 2.7

```
MQTT Broker—
IP      160.153.225.184
Port    1883
User Name
Password
Client Id
```

```
Logging—
Log Mo  OFF      WiFi
Sample  WiFi     5
Status  USB
        WiFi+USB
```

```
Logging Status—
EEPROM Mem      Empty
MQTT Connection  OK
```

1. Go to MQTT broker configuration menu and verify the credentials stored
2. Go logging menu and configure “Log Mode” via WiFi
3. Configure logging interval (Min Sample Time 5s)
4. Verify MQTT connections status

The logo is a circular gear-like emblem with a yellow center and orange outer ring. Inside the circle, the text "SmartPID" is written in a stylized font, with "Smart" in green and "PID" in orange. Below it, the word "CONTROLLER" is written in a smaller, black, sans-serif font. There are also three small orange stars at the bottom of the circle.

# step 3

SmartPID pairing with the app via  
serial number

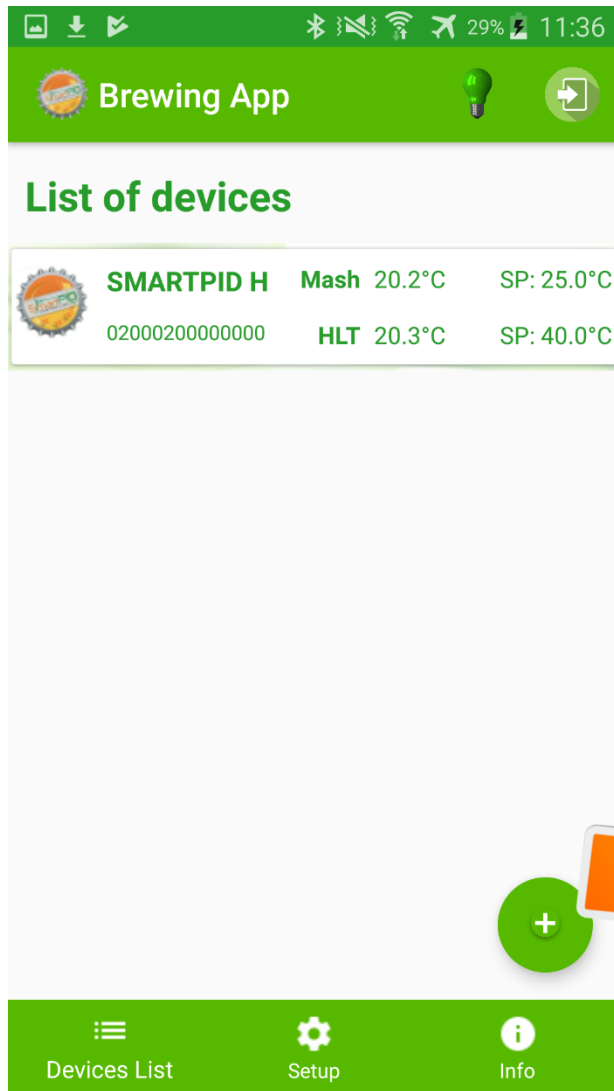

# step 3.1

1. You can add any number of remote controlled smartPID adding to your device list.
2. Press button to add a new one



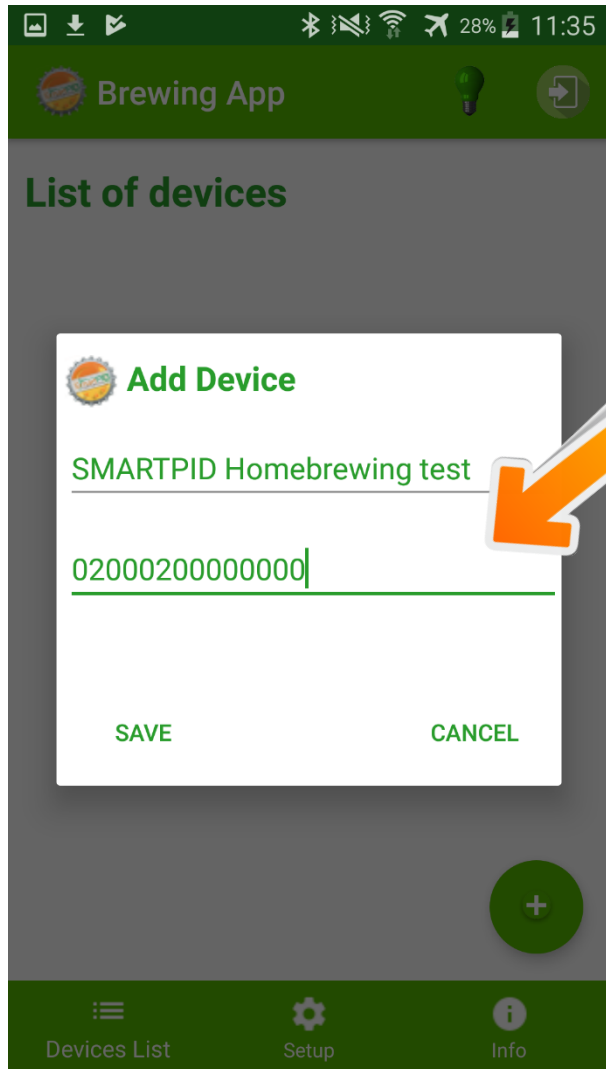

# step 3.2

1. Insert a mnemonic name
2. Insert serial number string that is displayed during boot sequence (14 chars)
3. Press **SAVE**



# step 3.3

1. The new smartPID controller has been added

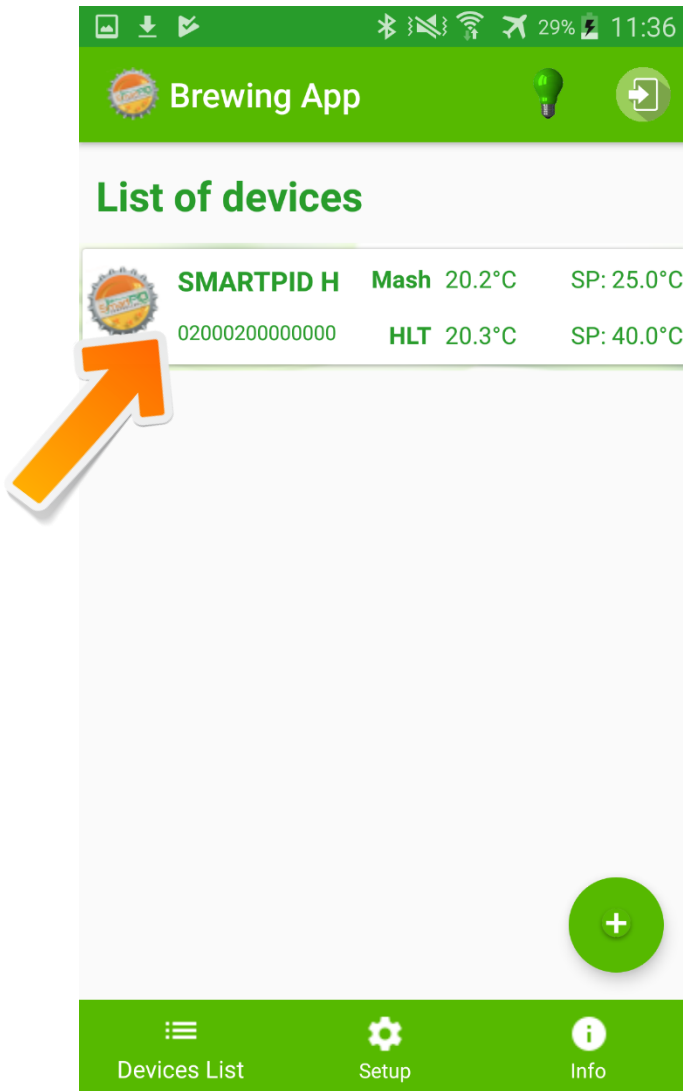



# step 3.4

1. It's possible to remove a device sliding left
2. It's possible to modify information sliding right